

# Mills Road/State Route 83 Roundabout Detour Map

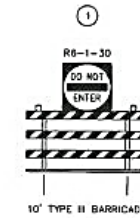

| 2'   | 3'   | 4'   | 5'   |
|--|--|--|--|
| ROAD CLOSED<br>2 MILES AHEAD<br>LOCAL TRAFFIC ONLY<br>R11-3A-60      | ROAD CLOSED<br>1.5 MILES AHEAD<br>LOCAL TRAFFIC ONLY<br>R11-3A-60    | ROAD CLOSED<br>1 MILES AHEAD<br>LOCAL TRAFFIC ONLY<br>R11-3A-60      | ROAD CLOSED<br>0.5 MILES AHEAD<br>LOCAL TRAFFIC ONLY<br>R11-3A-60    |
| 6  | 7  | 8  | 9  |
| DETOUR<br>NORTH<br>83<br>M4-B-30<br>M3-4-30<br>M1-5-30-2<br>M5-1L-30 | DETOUR<br>NORTH<br>83<br>M4-B-30<br>M3-4-30<br>M1-5-30-2<br>M5-1L-30 | DETOUR<br>NORTH<br>83<br>M4-B-30<br>M3-4-30<br>M1-5-30-2<br>M5-1R-30 | DETOUR<br>NORTH<br>83<br>M4-B-30<br>M3-4-30<br>M1-5-30-2<br>M5-1R-30 |
| 10   | 11   | 12   | 13   |
| DETOUR<br>NORTH<br>83<br>M4-B-30<br>M3-4-30<br>M1-5-30-2<br>M5-1R-30 | DETOUR<br>NORTH<br>83<br>M4-B-30<br>M3-4-30<br>M1-5-30-2<br>M5-1R-30 | DETOUR<br>SOUTH<br>83<br>M4-B-30<br>M3-4-30<br>M1-5-30-2<br>M5-1L-30 | DETOUR<br>SOUTH<br>83<br>M4-B-30<br>M3-4-30<br>M1-5-30-2<br>M5-1L-30 |
| 14   | 15   | 16   | 17   |
| DETOUR<br>SOUTH<br>83<br>M4-B-30<br>M3-4-30<br>M1-5-30-2<br>M5-1R-30 | DETOUR<br>SOUTH<br>83<br>M4-B-30<br>M3-4-30<br>M1-5-30-2<br>M5-1R-30 | DETOUR<br>SOUTH<br>83<br>M4-B-30<br>M3-4-30<br>M1-5-30-2<br>M5-1R-30 | DETOUR<br>SOUTH<br>83<br>M4-B-30<br>M3-4-30<br>M1-5-30-2<br>M5-1R-30 |
| 19   | 19   | 20   | 21   |
| ROAD CLOSED<br>AHEAD<br>500 FEET<br>W20-3-36<br>W16-2P-24            | ROAD CLOSED<br>AHEAD<br>1000 FEET<br>W20-3-36<br>W16-2P-24           | MILLS RD<br>DETOUR<br>0.3-1<br>M4-9R-30                              | MILLS RD<br>DETOUR<br>0.3-1<br>M4-9L-30                              |

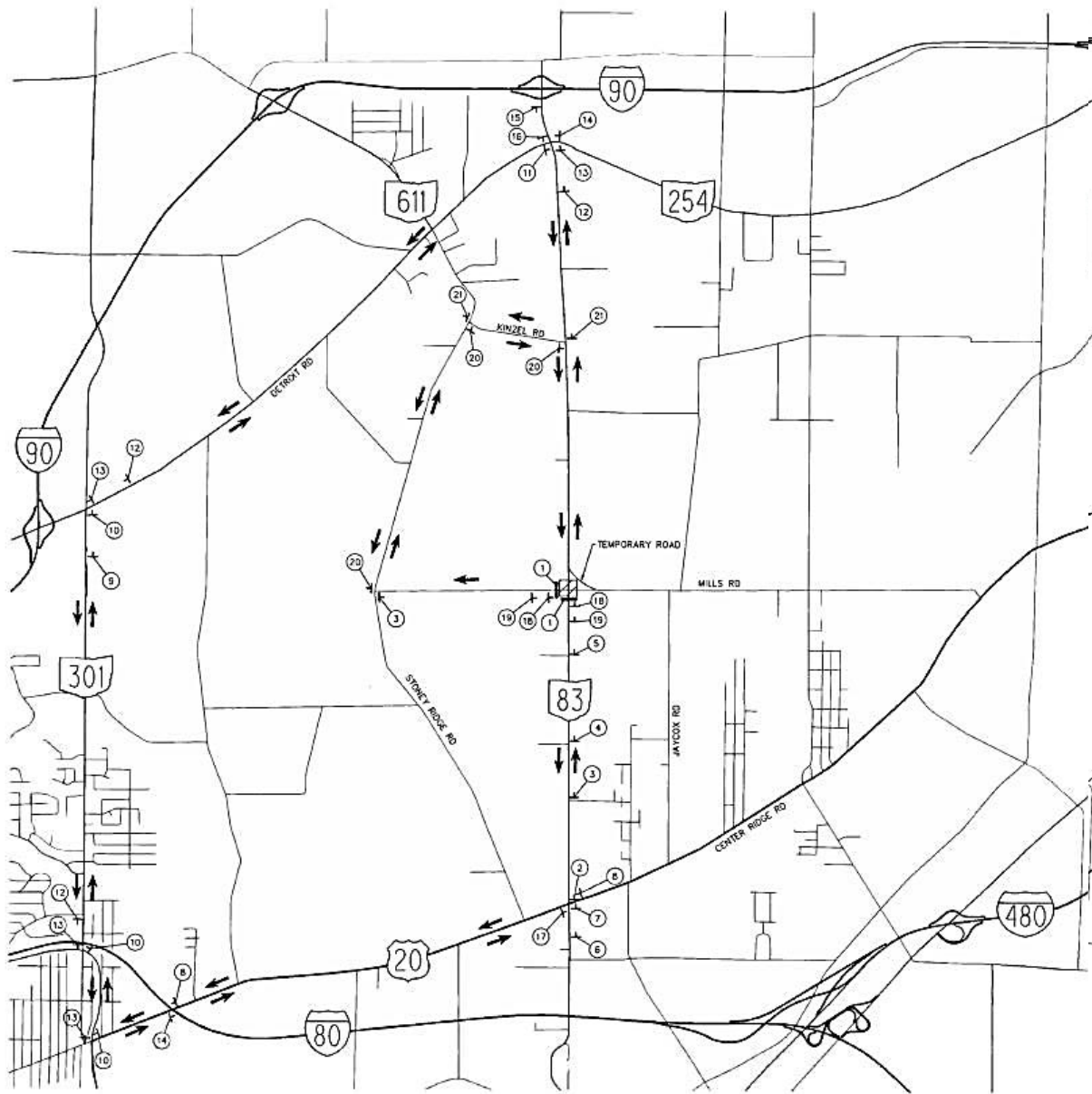