

Columbia Gas[®] of Ohio

A NiSource Company

JOB ORDER NUMBER (INSTALL) 15-0124011-00
JOB ORDER NUMBER (ABANDON) 15-0124012-00
PROJECT ID 15-34164
STONEY RIDGE ROAD RELOCATION
JOB TYPE: RELOCATION (561)

VICINITY MAP

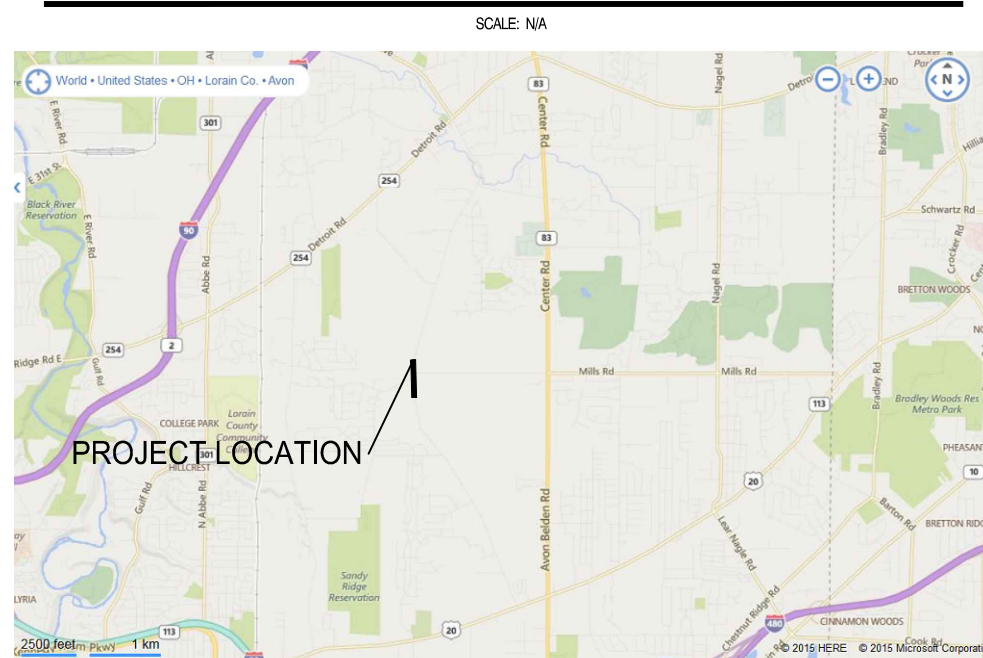

PROJECT DESCRIPTION

Relocate the existing gas main due to installation of a new sanitary sewer by the City of North Ridgeville.

PROJECT INFORMATION

FIELD ENGINEER/TECHNICIAN: ADAM WOODIE, P.E.
 CONSTRUCTION FLL: DAVE BRATTOLI AND MARK BAUER
 PERMITS: NONE
 TCC: 1222
 COUNTY: LORAIN COUNTY (093)
 TAX DISTRICT: 0470500
 MAP NUMBER: 3985-C
 SYSTEM NUMBER(S): 34364008
 24 HR. EMERGENCY LINE: COLUMBIA GAS OF OHIO
 1-800-344-4077

LEGEND

	EXISTING GAS MAIN		TEST WELL
	EXISTING GAS MAIN TO BE ABANDONED		REGULATOR STATION
	PROPOSED GAS MAIN		SINGLE CUSTOMER REGULATOR
	PROPOSED GAS MAIN UPRATE		METER
CS	COATED STEEL GAS MAIN		METER WITH REGULATOR
CI	CAST IRON GAS MAIN		TEST POINT (STATION)
BS	BARE STEEL GAS MAIN		GAS SERVICE TIE-OVER
WI	WROUGHT IRON GAS MAIN		GAS SERVICE REPLACEMENT
PH	HIGH DENSITY POLYETHYLENE GAS MAIN		METER MOVE OUT
PM	MEDIUM DENSITY POLYETHYLENE GAS MAIN		TELEPHONE MANHOLE
LP	LOW PRESSURE		DRAIN MANHOLE
IP	INTERMEDIATE PRESSURE		ELECTRIC MANHOLE
MP	MEDIUM PRESSURE		CATCH DRAIN
HP	HIGH PRESSURE		SEWER MANHOLE
AT	ATTACHED		FIRE HYDRANT
BH	BRIDGE HANGER		UTILITY POLE
BLGH	BUILDING HANGER		WETLAND
DB	DIRECTIONAL BORE		GAS VALVE
IS	INSERTED		CRITICAL GAS VALVE
OC	OPEN CUT		PRESSURE CONTROL FITTINGS
PB	PNEUMATIC BORE		TRANSITION
PL	PLOWED		END CAP
RT	ROOF TOP		REDUCER
(E)	EXISTING		ELECTRONIC MARKER
(P)	PROPOSED		
	WELD LOCATION		GAS MAIN TIE IN LOCATION
			GAS MAIN ABANDONMENT LOCATION

SHEET INDEX

DWG.	DESCRIPTION
T-1	TITLE SHEET
L-1	INSTALLATION SHEET
A-1	ABANDONMENT SHEET
D-1	CONSTRUCTION DETAILS

PROJECT SUMMARY TABLE

PROPOSED INSTALLATION			PROPOSED ABANDONMENT		
LENGTH (FT)	SIZE (IN)	TYPE	LENGTH (FT)	SIZE (IN)	TYPE
240'	4"	PM	237'	4"	PM
240'	TOTAL INSTALLATION (FEET)		237'	TOTAL ABANDONMENT (FEET)	
PROPOSED GAS SERVICES					
ESTIMATED GAS SERVICES		REPLACEMENTS	TIE OVERS	TOTAL SERVICES	METER OUTS

GENERAL NOTES

- THE PROPOSED GAS MAIN SHOWN IS APPROXIMATE AND SUBJECT TO CHANGE.
- PROPERTY LINE, STRUCTURES, STREET LINE, ETC. WAS COMPILED THE COLUMBIA GAS GIS DATA BASE AND ARE TO BE CONSIDERED APPROXIMATE.
- EXISTING UTILITIES, WHERE SHOWN, HAVE BEEN COMPILED FROM ABOVE GROUND EVIDENCE ONLY AND ARE TO BE CONSIDERED APPROXIMATE. COLUMBIA GAS DOES NOT GUARANTEE THE LOCATION OF THE UNDERGROUND UTILITIES SHOWN OR THAT ALL EXISTING UTILITIES AND/OR SUBSURFACE STRUCTURES ARE SHOWN.



PROPOSED

REVISIONS

REV. #	DATE	DESCRIPTION

DESIGNED BY	DATE	PHONE #
DRAWN BY	DATE	PHONE #
CHECKED BY	DATE	PHONE #
AS-BUILT BY	DATE	PHONE #

SITE NAME:
JO# 15-0124011-00
JO# 15-0124012-00
PROJECT ID# 15-34164
 STONEY RIDGE ROAD RELOCATION
 CITY OF NORTH RIDGEVILLE, LORAIN COUNTY

DRAWING TITLE:
 TITLE SHEET

DRAWING NO:
T-1



Ohio Utilities Protection Service
Call 811
 before you dig

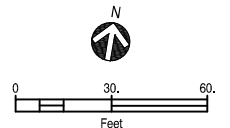

PROPOSED

REVISIONS

REV. #	DATE	DESCRIPTION

DESIGNED BY			
DRAWN BY			
CHECKED BY			
AS-BUILT BY			
	NAME	DATE	PHONE #

SITE NAME:
JO# 15-0124011-00
JO# 15-0124012-00
PROJECT ID# 15-34164
 STONEY RIDGE ROAD RELOCATION
 CITY OF NORTH RIDGEVILLE, LORAIN COUNTY

PROJECT TITLE:
 INSTALLATION SHEET

DRAWING NO:
L-1

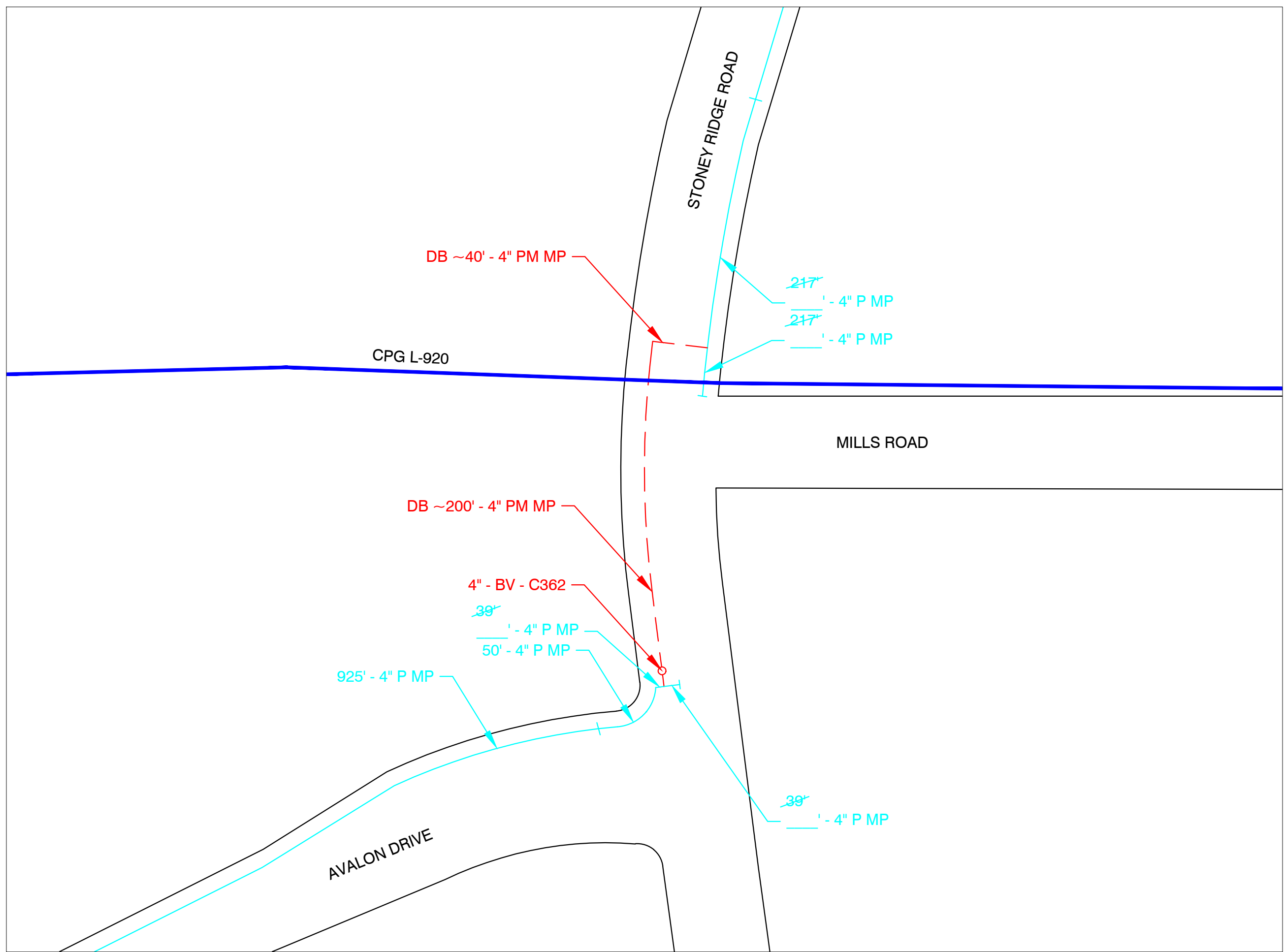

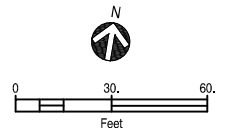

ABANDONMENT

REVISIONS

REV. #	DATE	DESCRIPTION

DESIGNED BY			
DRAWN BY			
CHECKED BY			
AS-BUILT BY			
	NAME	DATE	PHONE #

SITE NAME:
JO# 15-0124011-00
JO# 15-0124012-00
PROJECT ID# 15-34164
 STONEY RIDGE ROAD RELOCATION
 CITY OF NORTH RIDGEVILLE, LORAIN COUNTY

PROJECT TITLE:
 ABANDONMENT SHEET

DRAWING NO:
A-1

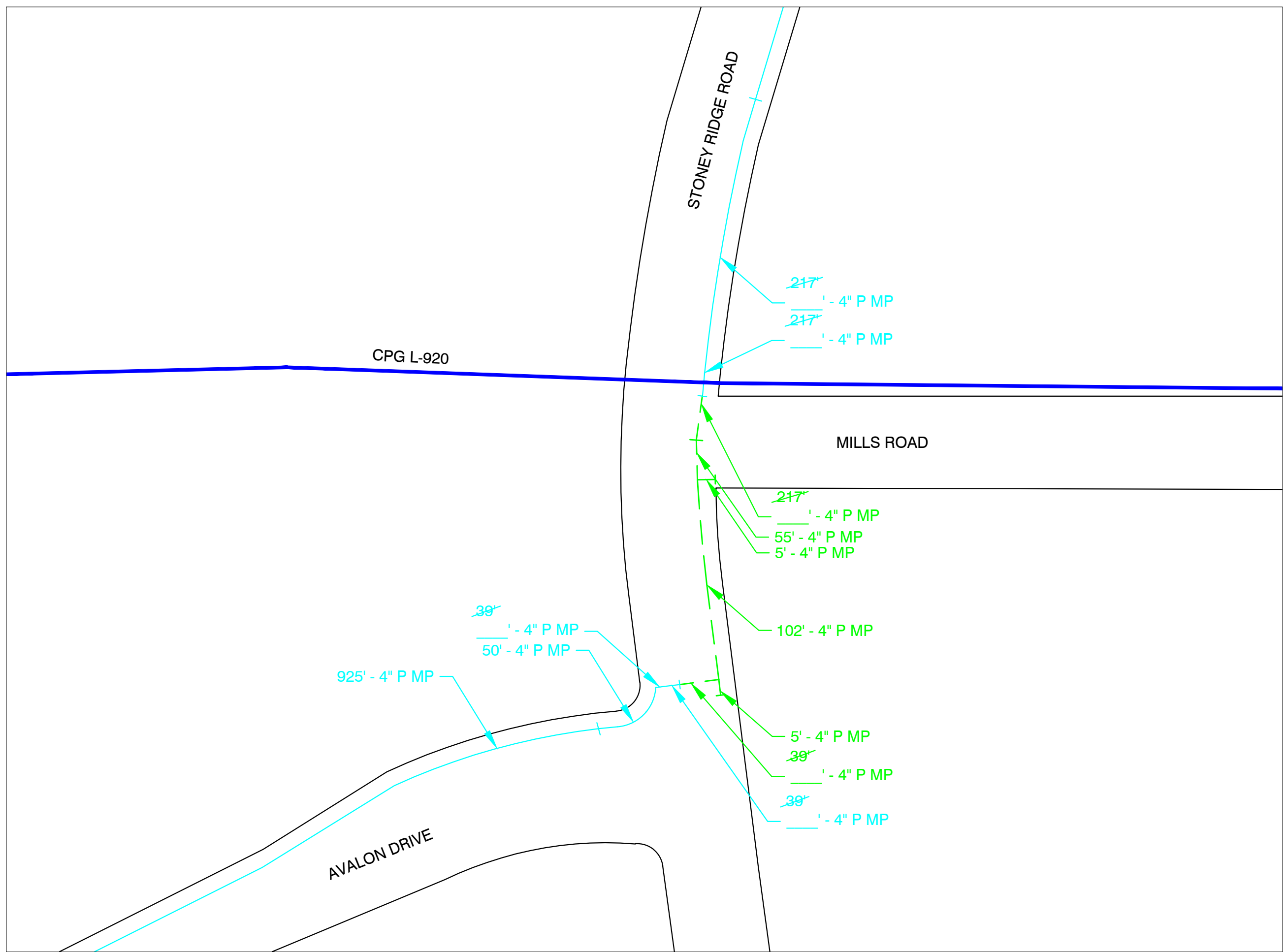

AS-BUILT NOTES -- (TO BE COMPLETED DURING CONSTRUCTION)

PIPELINE PRESSURE TEST DATA			
<input type="checkbox"/> CGV <input type="checkbox"/> CKY <input type="checkbox"/> CMA <input type="checkbox"/> CMD <input type="checkbox"/> COH <input type="checkbox"/> CPA <input type="checkbox"/> NIPSCO			
LOA/TCC: _____		WO/JO: _____	
RECORDING CHART <input type="checkbox"/> YES <input type="checkbox"/> NO		RECORDER SERIAL NO: _____	
PRESSURE SYSTEM NO: _____		REQUIRED MAOP: _____	
		TEST ACCEPTABLE: <input type="checkbox"/> YES <input type="checkbox"/> NO	
PIPELINE LOCATION (STREET, CITY, TOWN OR COUNTY)	LENGTH	SIZE	PE/STEEL
TEST DATE: _____ TEST MEDIUM: _____ TEST PRESSURE: _____			
START TIME: _____		STOP TIME: _____	
DURATION: _____		CONTRACTOR (IF APPLICABLE): _____	
PRINT NAME: _____			
REMARKS*: _____			
* DESCRIBE ANY LEAKAGE OR FAILURES FOUND DURING THE TEST AND THEIR DISPOSITION. NOTE SIGNIFICANT ELEVATION VARIATIONS ON WATER TESTS.			
FORM GS 1500.010-1 (5-2014)			



PROPOSED

REVISIONS		
REV. #	DATE	DESCRIPTION

DESIGNED BY			
DRAWN BY			
CHECKED BY			
AS-BUILT BY			
	NAME	DATE	PHONE #

SITE NAME:
JO# 15-0124011-00
JO# 15-0124012-00
PROJECT ID# 15-34164
 STONEY RIDGE ROAD RELOCATION
 CITY OF NORTH RIDGEVILLE, LORAIN COUNTY

DRAWING TITLE:
 CONSTRUCTION
 DETAILS

DRAWING NO:
D-1